

3.96mm Wire To Board Header Straight (R/A) Type

■ **MATERIAL**

Insulator : Polyester
Contact Pin : Brass



■ **SPECIFICATION**

Current Rate : 5 AMP
Insulation Resistance : 1000MΩ MIN.
Contact Resistance : 20mΩMax.
Operation Temperature : -25°C to +85°C

■ **Detail Dimensions**

731-71-xxTW01

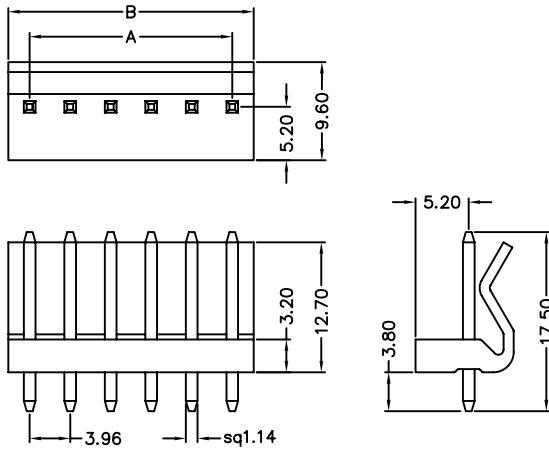

731-72-xxTW01

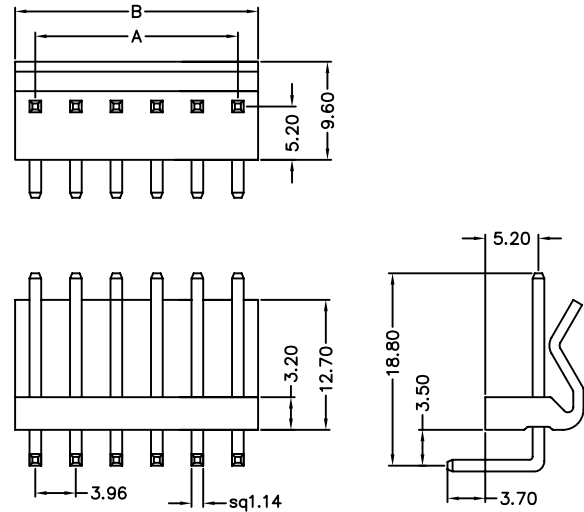

■ **Recommended P.C.B Layout**

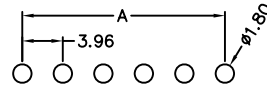
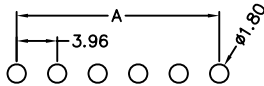

■ **Order Information**

731-7 x - xx T W xx
1 2 3 4 5

1. 1: Straight Type
2: Right Angle Type
2. No. of contacts
3. T: Tin Plating
4. W: White Insulator
5. Pinrex internal code

Standard Parts	Type
731-71-xxTW01	Straight
731-72-xxTW01	Right Angle

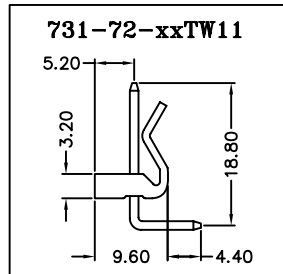

■ **Number Of Contacts**

Unit: mm

Poles	DIM A	DIM B	Poles	DIM A	DIM B	Poles	DIM A	DIM B						
2	3.96	8.00	9	31.68	35.80	16	59.40	63.80						
3	7.92	12.00	10	35.64	43.90	17	63.36	67.70						
4	11.88	15.90	11	39.60	47.80	18	67.32	71.70						
5	15.84	20.00	12	43.56	51.80	19	71.28	75.60						
6	19.80	24.00	13	47.52	55.70	20	75.24	79.80						
7	23.76	27.90	14	51.48	59.80									
8	27.72	31.90	15	55.44	59.80									